

LD72



Miniature Low Glare LED Downlight

Data sheet - Page 1

LD72 is a miniature, LED downlight, ideal for display, niches or general downlighting effects. It is very discreet with the LED set back by 10mm to reduce the glare, and a painted bezel which can be matched to the mounting surface. It utilizes the latest LED technology with a typical CRI of 93 in warm white. IP40 as standard, but can be specified IP54 for bathrooms or wet environments.

Key Features

- Very minimal depth and bezel diameter
- High power for its size
- High efficiency optics specially designed for LightGraphix guarantee excellent beam spread and shape
- Recessed LED position for reduced glare
- Optional IP54 version for wet areas, comes with glass and gasket
- Hidden fixing options include spring clips
- Simple and fast installation
- Available with Switch, 0-10V, DMX, Dali or Mains dimmable drivers

Specification

Applications



Beam Angles 12°, 31°, 48°, 36° x 12°

LED type 1 x Cree XPG

Colour temperature	2700K / 3000K			5000K		
	350	500	700	350	500	700
Drive Current (mA)	350	500	700	350	500	700
LED power* (W)	1.2W	1.7W	2.4W	1.2W	1.7W	2.4W
CRI (typical)	93	93	93	75	75	75
Forward voltage (V) ₁₀₀	3.0V	3.2V	3.4V	3.0V	3.2V	3.4V
Delivered lumens (L ₁₀₀)	75	99	127	116	153	197
Lumens per circuit watt**	63	58	53	97	90	82

LED lifetime (to 70% lumen maintenance) 50,000hrs at a max ambient temperature of 35°C (if specifying fitting in ambient temperatures of up to 45°C run at 500mA max, LD72-500)

Materials Anodised aluminium body

Glass 1.2mm thick borosilicate (IP54 version only)

Wiring Comes pre-wired with 2 core 100mm lead, can be specified with up to 10m at extra cost

IP rating IP40 standard (optional IP54)

*LED wattage includes losses associated with using an 85% efficient driver

**data shown allows for an ambient temperature of 35°C

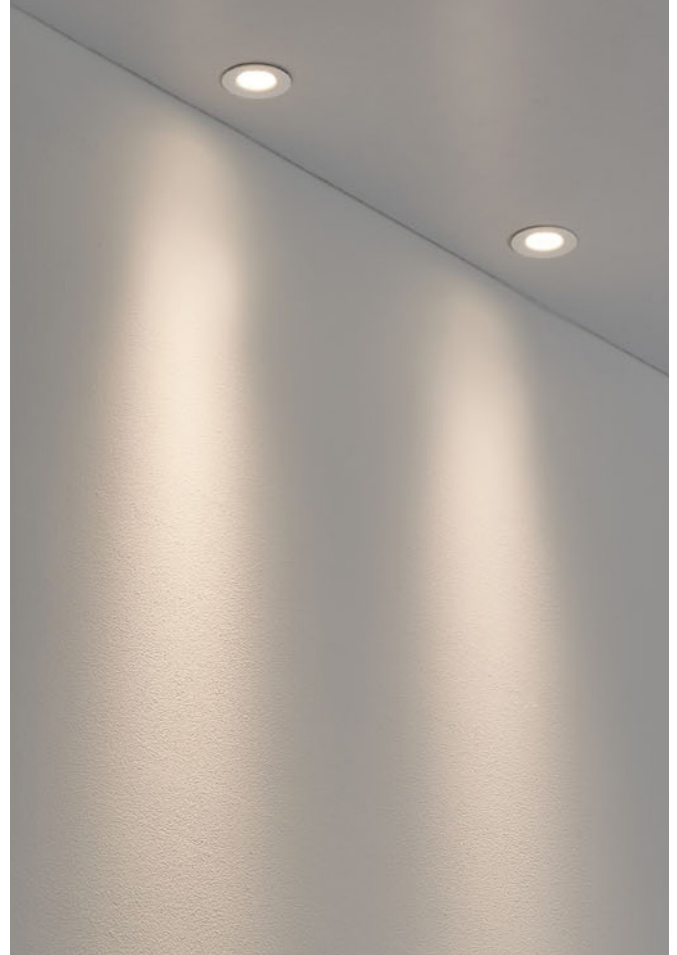

LD72



Miniature Low Glare LED Downlight

Data sheet - Page 2

Dimensions and Fixing Options

LED and optic position recessed by 10mm for reduced glare.

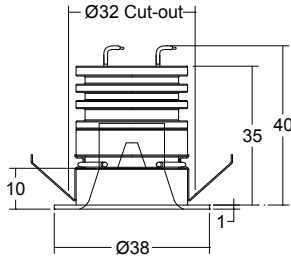

IP54 rated version is supplied with an extra gasket which sits between the bezel and the mounting surface.

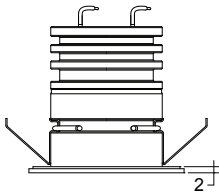

Photometrics

Photometric files are included in the design pack which can be downloaded from the LD72 product page on the website.

Order Codes and Options

Product code	LED colour	Lens angle	IP rating	Finish
LD72 - 350 - 500 - 700	<input type="text"/>	<input type="text"/>	<input type="text"/>	<input type="text"/>

Example: LD72-700 / LW30 / MB / IP54 / White

Product codes with output options

1.2W LED at 350mA	LD72-350
1.7W LED at 500mA	LD72-500
2.4W LED at 700mA	LD72-700

LED colour options

LED colour options	Suffix
Extra warm white (2700K)	/LW27
Warm white (3000K)	/LW30
Cool white (5000K)	/LW50
Blue	/LB
Green	/LG
Red	/LR
Amber	/LA

Beam / lens angle options

12° narrow spot	/NB
31° medium	/MB
48° wide	/WB
36° x 12° oval beam	/OB

IP Rating

IP40 (dry internal use as standard)	/IP40
IP54 rated for moist environments	/IP54

Bezel finish options

Paint finish silver / black / white (RAL 9016) / RAL
 Chrome finish (minimum order - please contact us)

Use with 350mA, 500mA or 700mA constant current LED drivers

We have a wide range of dimmable LED drivers, 0-10V, DMX, DALI and Mains dimmable. Please see the downloads section on our website:
 To run 1-14 LD72-500 in series use a TXDEL500D (0-10V dimmable)
 To run 1-13 LD72-700 in series use a TXDEL700D (0-10V dimmable)