

LD170-F1

Bulkwalk Mounted Uplighter



Install sheet - Page 1

SPECIFICATION

LED recessed luminaires are class III for Safety Extra Low Voltage **DC** supply. The product should only be used with a supplied or LightGraphix approved **350mA** or **500mA** constant current driver.

Suitable for mounting on normally flammable surfaces.

Lamp: **F1 LED Engine.**

This fitting is **IP67** rated.

Lumen Maintenance: L90B5 at 90,000hrs.

LD170 - F1	
Product & LED Output Code	Power Output
LD170-F1 - 350	350mA 3.5W
LD170-F1 - 500	500mA 5W

Glare Shield Alignment

/GS

Glare Shield

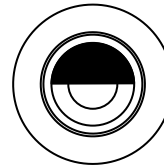

Floor

DIAGRAM

LD170 - /485S

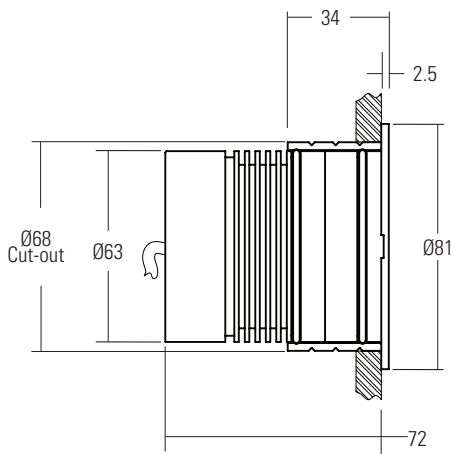

INSTALLATION

/485

Fixing Sleeve

1. Bore Ø68 clearance hole in to mounting surface.
2. Bond in first fix sleeve into cut out with one of the recommended adhesives; **Rotabond 2000, 3M 4200 Marine Adhesive or Simson MSR Construction Adhesive.**
3. Pull through cables and wire luminaire to specified driver.
NOTE: Connections in wet environments. Make IP68 connection to stop water travelling up the cables into the fittings! Refer to IP connection sheet for further details.
4. Make sure the inside of the fixing sleeve and the outside of the luminaire is free from grit, dirt.
5. To aid future maintenance the exterior O-rings should be lightly greased with silicone free grease.
6. Install fitting by pushing it into the sleeve.
7. Check the orientation of the fitting, the glare shield should be parallel to the walkway, please see diagram above.
8. Confirm installation was successful by powering up the fitting. If there is no light output, switch off power immediately and verify wiring.

LD170-F1

Bulkwalk Mounted Uplighter



Install sheet - Page 2

DIAGRAM

LD170 - /SC

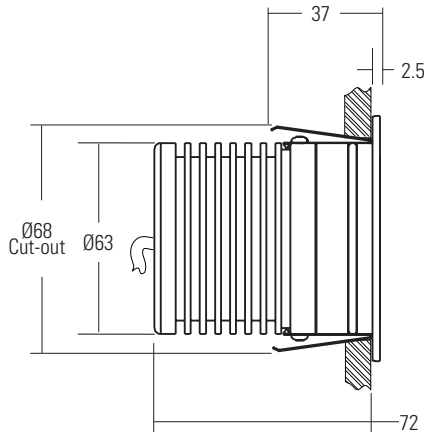

INSTALLATION

/SC

Spring Clips

1. Prepare cut out: Ø68mm
2. Feed cable through to the driver's location. Connect luminaire to the specified driver, ensuring it is disconnected from the mains side. **NOTE: Connections in wet environments. Make IP68 connection to stop water travelling up the cables into the fitting!**
3. Compress springs against the side of the fitting.
4. Rotate fitting anti-clockwise to allow the springs to bite into the mounting surface. This will help it stay securely in place.
5. Check the orientation of the fitting, the glare shield should be parallel to the walkway, please see diagram above.
6. Confirm installation was successful by powering up the fitting. If there is no light output, switch off power immediately and verify wiring.

SEE CONSTANT CURRENT WIRING SHEET FOR IN SERIES WIRING DIAGRAM

WIRING

Do not power up until fitting is wired correctly! Constant current LEDs must be wired in series, polarity is critical. Please refer to specified driver sheet for details on the minimum and maximum number of LEDs per circuit.

IMPORTANT

Make sure that all cables and connections are securely connected before switching on the power. Failing to do this can lead to failure of the LEDs and/or the driver. If the LEDs do not work upon power up, turn off the power source immediately and check the polarity of the wiring. Any attempt made to open up and/or modify the luminaire will invalidate the manufacturers warranty. This is inclusive of but not limited to removal of the LightGraphix product label or removal of any parts from the main body of the product including bezels, electrical components and factory fitted fixing methods (unless otherwise stated in these instructions).

CORE COLOUR & POLARITY		
Colour of Cable	Red	Black
Polarity	+	-

MAINTENANCE

Clean with soft damp cloth.
LED: Please contact LightGraphix.
O-ring replacement part numbers: Outer O-ring 17.0062