

WARNING: DO NOT USE NORMAL LOW VOLTAGE TRANSFORMERS WITH LEDs.

All LED fittings are tested before dispatch. It is not necessary to check them on site. Do not power up until fittings are wired correctly.

INSTRUCTION LEAFLET



LD36 (White 2-Core Cable)

Linear LED Luminaire

This product should be installed by a qualified electrician in accordance with all current, local legislation. For the UK, the current edition of the IEE Wiring Regulations and European Standard IEC 60364.

SPECIFICATION

LED Linear luminaires are class III  for Safety Extra Low Voltage supply  **350mA to 500mA** constant current supply.

Suitable for mounting on normally flammable surfaces. 

This fitting is **IP40 to IP54** rated, please check specification.

Lumen Maintenance: 50,000 hours L70 at Max Ambient of 35°C.

LD36 is available in various power outputs options	
Product & LED output code	Power Output
LD36 - 350	350mA 1.2W (per LED)
LD36 - 500	500mA 1.7W (per LED)

INSTALLATION

1. See page 2 for minimum slot, LED spacing and wiring details. Care and attention must be given to the 2-core cable supplied with the LD36.
2. When installing make sure mount surface is sound and is free from dirt.
3. Fix using one No. 4 or 6 Screw per spring clip or bracket.
4. The correct number of brackets will be pre-installed on each length.
5. If using the spring clip, the correct amount will be supplied to install one every 0.5m.
6. It is very important that the product is installed correctly and not allowed to bend or sag.
7. The adjustable bracket may need locking off after focusing. To do so please use a 3mm Allen key.
8. Wire the luminaire to a specified driver.

NOTE: Connections in wet environments. Make IP68 connection to stop water travelling up the cables into the fittings! Refer to IP connection sheet for further details.

DIMENSIONS

/SC
Spring Clip Fixing

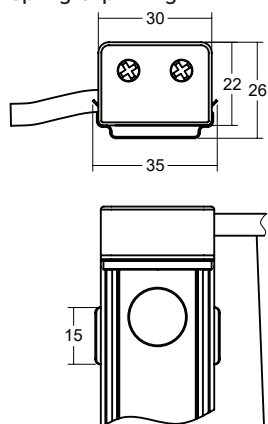

/BSM
Bracket Side Mounting

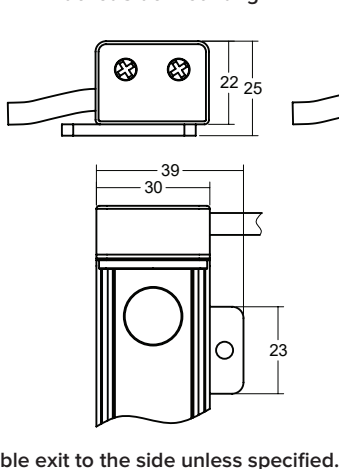

/BEM
Bracket End Mounting

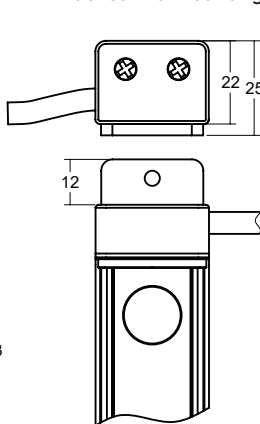

/ABM
Adjustable Bracket Mounting

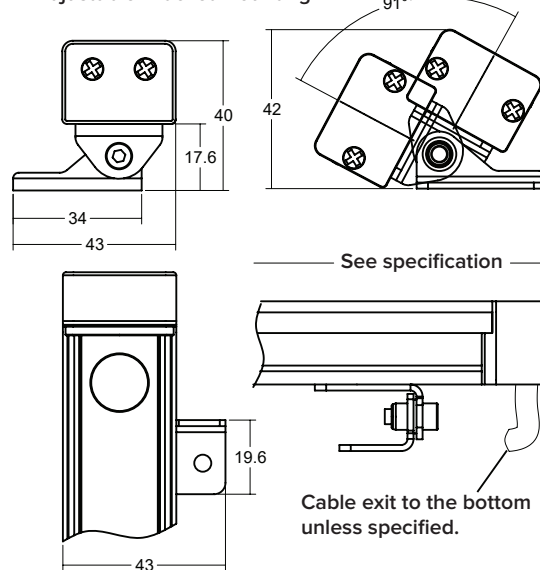

/NB
Narrow Beam

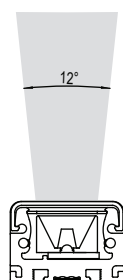

/MB
Medium Beam

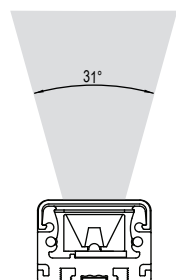

/WB
Wide Beam

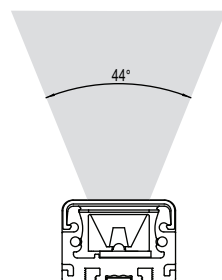

/OB
Oval Beam

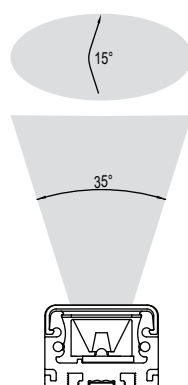

/GL36
Anti Glare Louvre

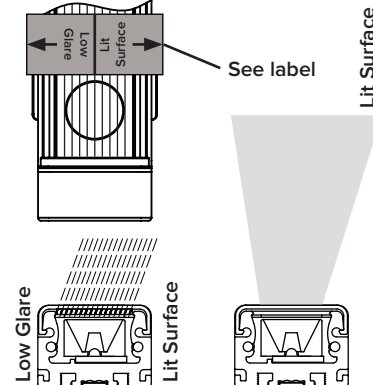

Beam angles given in (FWHM) full width at half maximum.

WARNING: DO NOT USE NORMAL LOW VOLTAGE TRANSFORMERS WITH LEDs.

All LED fittings are tested before dispatch. It is not necessary to check them on site. Do not power up until fittings are wired correctly.

INSTRUCTION LEAFLET



LD36 (White 2-Core Cable)

Linear LED Luminaire

This product should be installed by a qualified electrician in accordance with all current, local legislation. For the UK, the current edition of the IEE Wiring Regulations and European Standard IEC 60364.

INSTALLATION

Minimum width of slot detail

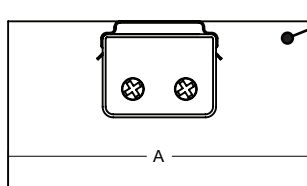

Max ambient of 35°C

It is recommended to incorporate air vents into all slot details to stop the ambient temperature increasing too high.

Product code	A (mm)
Spring Clip	40
Side Bracket	40
End Bracket	30
Adjustable Bracket	45

If recessing luminaire in a tight channel (30mm) run fitting at 350mA Max.

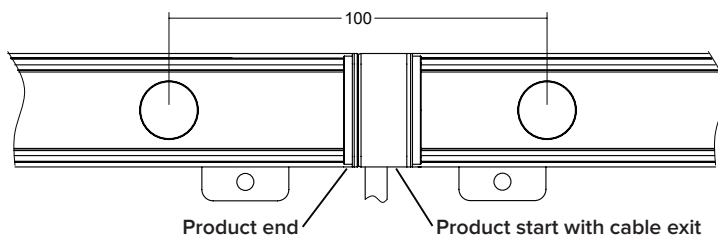
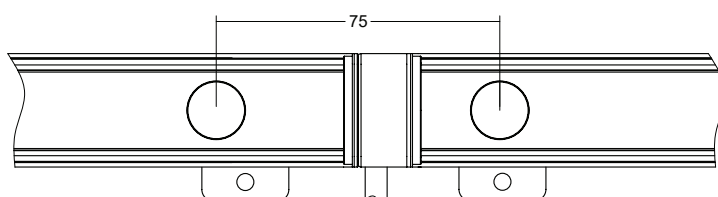
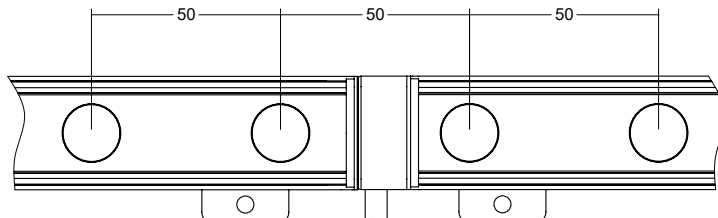

PRODUCT SPACING

To maintain LED spacing, butt fittings start to end as shown in the diagram.

2 metres of cable is supplied as standard unless specified longer.

LINKED SECTIONS SPACING

Sections hard wired to specified spacing.

2 metres of cable is supplied as standard unless specified longer.

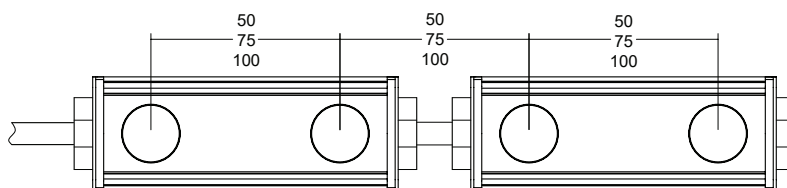

WIRING

Do not power up until fitting is wired correctly! Constant current LEDs must be wired in series, polarity is critical! Please refer to specified driver sheet for details on the minimum and maximum number of LEDs per circuit.

Single Colour LEDs		
Circuit	Circuit 1	
Colour of Cable	Brown	Blue
Polarity	+	-

SEE CONSTANT CURRENT WIRING SHEET FOR IN SERIES WIRING DIAGRAM

IMPORTANT

Make sure that all cables and connections are securely connected before switching on the power. Do not switch on the power source prior to making these connections as this will result in the LEDs being overvolted, which can lead to failure of the LEDs and/or the driver. If the LEDs do not work upon power up, turn off the power source immediately and check the polarity of the wiring.

MAINTENANCE

LAMPS: Non Replaceable.
Clean with soft cloth.

This leaflet should be issued and retained by the end user.

Page 2/2